



# Doune **TRAIL**

78701003

EN1176-1:2017 | EN1176-11:2014



**5+**

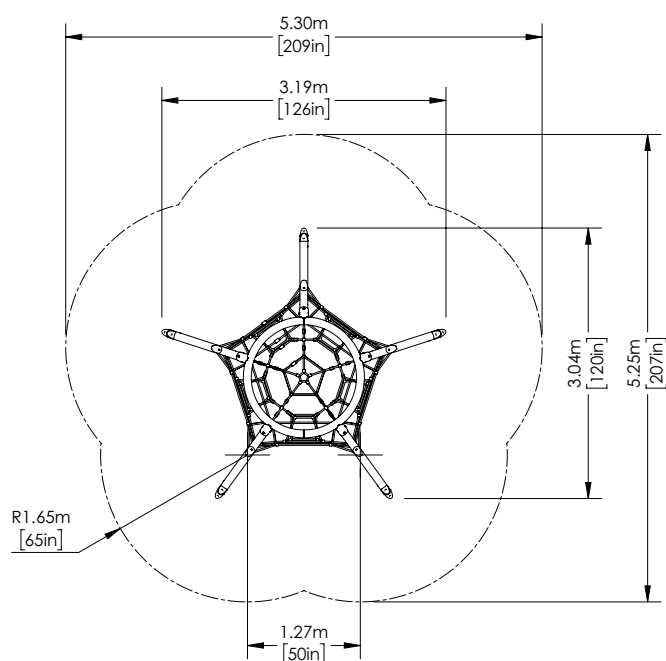
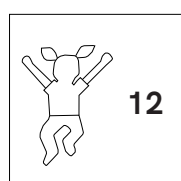
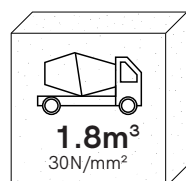
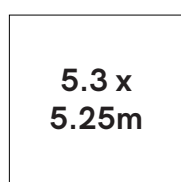
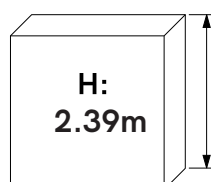
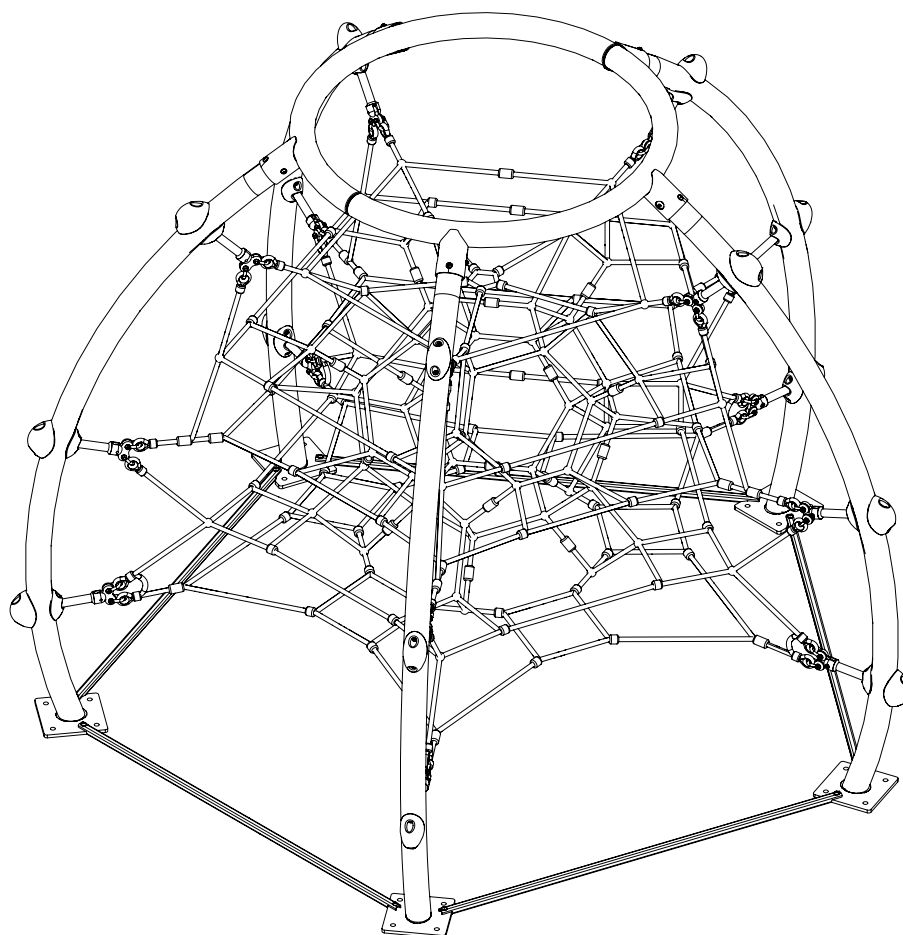





*Black Powdercoat Steelwork*



*16mm & 18mm Braided Rope*



*Recycled Rubber & Plastic*



*Aluminium Trapeze*



*10mm Flexform*



*Pressed  
Aluminium  
Ferrules*



*Pressed  
Aluminium  
Connectors*



*Combine into a play TRAIL*



*Climb, Balance, Traverse, Run, & Jump*



*Recycled Rubber Steppers*