

5 30 025 0







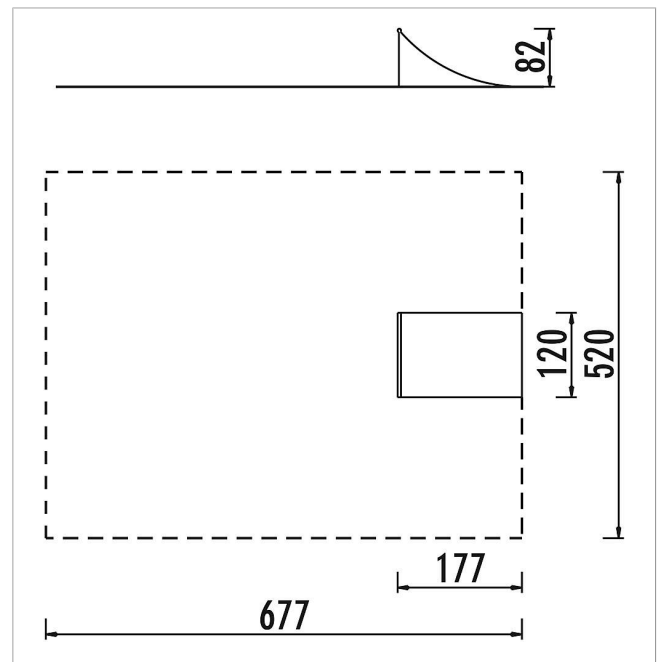

**eibe rampart Jump  
Ramp 0.8**

made in germany



**Volumen del suministro**



	Material	Acero, PRF
	Nivel fundamento	-
	Espacio mínimo	677x520x582 cm
	Altura de caída libre	-
	Prot. contra caídas neto	-
	Fundamentos	-
	Montaje	1 persona/1 h
	Pieza más grande	177x120x82 cm
	Pieza más pesada	150 kg